



CONTACTS BLOCK TYPE BC-ST FOR SOLITERM SUPPORT



DESCRIPTION

The Contacts block for SOLITERM Support is a part of a measuring chain for quick determination of equivalent carbon in cast iron and nonferrous alloys used for taking over and transmitting the signal from the thermocouple inside the sensor (SOLITERM) to the indicating instrument through the compensation cable of the SOLITERM support.

The product has contact electrodes type Cromel-Alumel.

TECHNICAL DATA

- Dimensions : $\square 45 \times 71$ mm.
- The Contacts block is fixed on the support by a threaded pin
- Operating time : min. 300 measurements

Symbolising

: BC-ST-2K

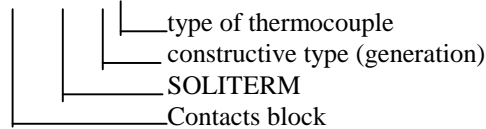

BC-ST-2K
Contacts block SOLITERM
(min. 300 measurements)

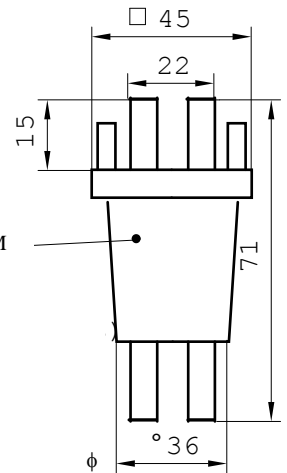

ORDERING

Ex.: Contacts block type **BC-ST-2K** ... 18 pieces for SOLITERM support type SST-2K.

APPLICATION

